

L X  
S E R I E S

WWW.MISSION.CO.UK

MISSION



MUSICAL PERFORMANCE

#### OVERVIEW

## A TRULY MUSICAL PERFORMANCE

WHAT MAKES A GREAT LOUDSPEAKER? WHAT MAKES IT SING? TO MISSION THE ANSWER IS SIMPLE: IN A WELL MATCHED SYSTEM, THE SPEAKERS HAVE TO ALLOW THE PERFORMANCE OF THE MUSIC TO SHINE THROUGH. IT'S NOT A GROUP OF NOTES; IT'S A PERFORMANCE. IT'S NOT ALL ABOUT FREQUENCY RESPONSE, IMPEDANCE, SENSITIVITY AND DIRECTIVITY, ALTHOUGH THEY ALL PLAY A PART. TO PARAPHRASE A FAMOUS EXPRESSION, IT'S THE MUSIC, THE WHOLE MUSIC AND NOTHING BUT THE MUSIC - THAT, IN A NUTSHELL IS MISSION'S PHILOSOPHY.

FOR THE LX SERIES THE SPEAKERS' DESIGN HAS BEEN STRIPPED BACK TO ITS FUNDAMENTALS AND MISSION HAS FOCUSED ON PRODUCING A RANGE OF SPEAKERS THEY ARE PROUD OF IN ENGINEERING TERMS, BUT CAN BE EVEN MORE PROUD OF IN TERMS OF THE ENJOYMENT THEIR OWNERS WILL EXPERIENCE.

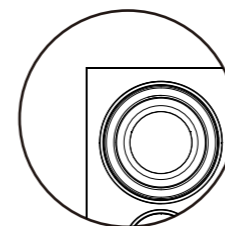

MODERN DESIGN

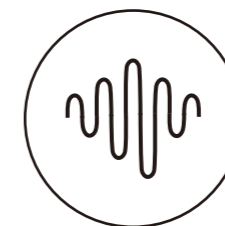

VIBRANT SOUND



ADVANCED CAD  
MODELLING

## DESIGN

# MUSIC IS THE MASTER; TECHNOLOGY IS THE SLAVE

LX SERIES SPEAKERS ARE SMART, PRACTICAL AND AFFORDABLE, SPORTING A SHARP, CLASSIC BUT MODERN LOOK IN KEEPING WITH MISSION'S CUSTOMARY DESIGN FOCUS. ABOVE ALL, THEY COMMUNICATE MUSIC WITH ENGAGING ENERGY AND DETAIL, BRINGING PERFORMANCES TO LIFE WITH ALL THE VIBRANCY AND FINESSE ONE EXPECTS OF MISSION SPEAKERS.

MISSION'S ETHOS HAS ALWAYS FOCUSED UPON BRINGING AUDIOPHILE PERFORMANCE DOWN TO AN AFFORDABLE LEVEL, AND THE LX SERIES EXEMPLIFIES THIS. WITH THE AID OF SOPHISTICATED MODELING TOOLS AND SOFTWARE, WE'VE BEEN ABLE TO MAXIMISE THE PERFORMANCE OF THE SERIES USING THE MOST MODERN TECHNOLOGY AVAILABLE. YET MISSION'S ORIGINAL SLOGAN, 'MUSIC IS THE MASTER, TECHNOLOGY IS THE SLAVE', HAS NEVER BEEN MORE APT. ULTIMATELY ALTHOUGH IT'S POSSIBLE TO DESIGN A LOUDSPEAKER THAT MEASURES BADLY BUT STILL SOUNDS GOOD TO MOST, IT TENDS TO BE VERY ROOM DEPENDENT AND THAT IS NOT OUR WAY. GREAT SOUND AND GOOD MEASUREMENTS KEEP US VERY HAPPY. - WHICHEVER MISSION LX SPEAKER YOU SELECT, YOU'LL WANT TO EXPLORE YOUR WHOLE MUSIC COLLECTION ALL OVER AGAIN.



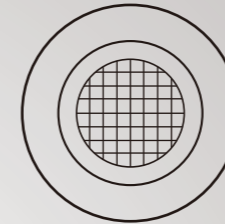
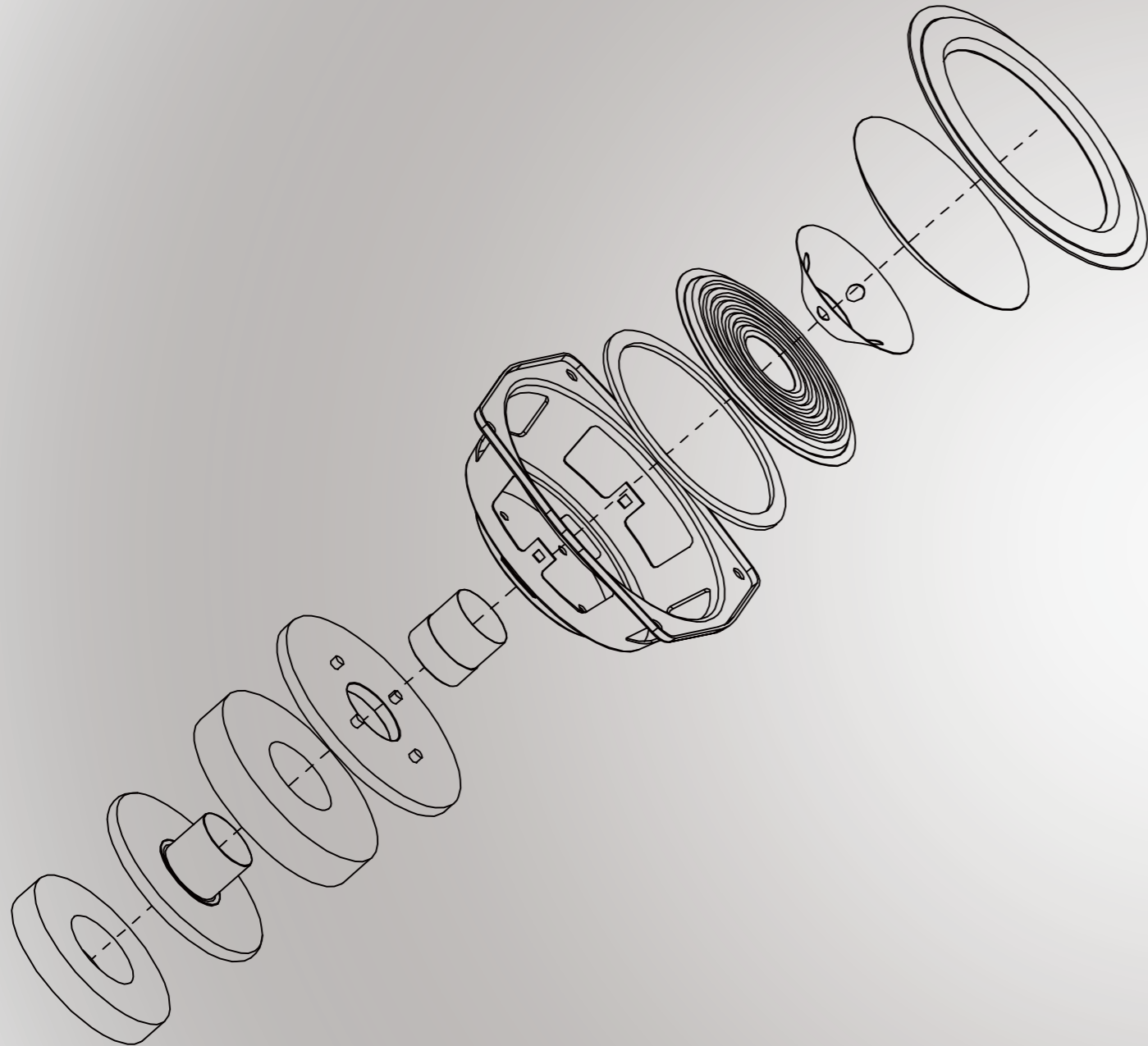

MICROFIBRE TWEETER

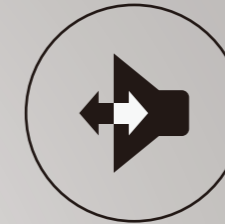

LINEAR EXCURSION  
WOOFER

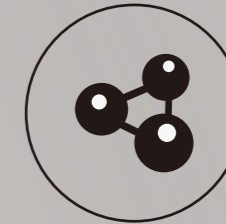

PROPRIETARY CONE  
MATERIAL

## TECHNOLOGY

# ADVANCED DRIVER DESIGN

HIGH FREQUENCY DRIVE UNITS REQUIRE EXTREMELY CONSISTENT PARTS WHICH TOGETHER WITH MISSION'S EXTREMELY CONSISTENT MANUFACTURING CAN DELIVER THE PERFORMANCE REQUIRED. GIVEN THE TINY MOVING MASSES INVOLVED, ONE MICRO-DROP EXTRA OF HIGH-TECH ADHESIVE CAN DESTROY THE BALANCE OF THE DESIGN, THUS AFFECTING SENSITIVITY AND FREQUENCY RESPONSE.

FOR THE LX SERIES, MISSION HAS CAREFULLY DESIGNED A TWEETER WITH A NEODYMIUM MAGNET FOR MAXIMUM FORCE IN A SMALL SPACE, TOGETHER WITH A 25MM MICROFIBER DOME CHOSEN FOR ITS REPEATABILITY AND CONSISTENCY IN MANUFACTURE. IT DELIVERS A SWEET SOUNDING BUT INCISIVE UPPER FREQUENCIES AS REQUIRED.

THE LX-1, LX-2, LX-3 AND LX-4 ARE TWO-WAY DESIGNS, COMBINING THE 25MM MISSION TWEETER WITH ONE MID/BASS DRIVER IN THE LX-1 AND LX-2, AND TWO MID/BASS DRIVERS IN THE LX-3, LX-4 AND LX-C. THE LX-5 IS A THREE-WAY DESIGN. THE MIDRANGE AND MID/BASS DRIVERS USE CONES MANUFACTURED FROM AN ADVANCED FIBRE FORMULATION, IMPREGNATED TO REDUCE HYGROSCOPY AS WELL AS BEING VERY STIFF FOR THEIR MASS, WITH EXCELLENT SELF-DAMPING. WITH THE USE OF A POWERFUL FERRITE MAGNET, THE MAGNETIC FIELD IS DIRECTED PRECISELY WITHIN THE AREA OF VOICE COIL EXCURSION, ENABLING AN ULTRA-LINEAR PERFORMANCE THAT MINIMISES COLOURATION.





## TECHNOLOGY

# DRIVE UNIT POSITIONING AND INTEGRATION

IN TRADITIONAL MISSION STYLE, THE STANDMOUNT LX-1 AND LX-2'S TWEETER IS POSITIONED BELOW THE MID/BASS DRIVE UNIT, IN ORDER TO AID TIME ALIGNMENT. BY PLACING THE TREBLE UNIT LOWER THAN EAR LEVEL, THE PATH LENGTH FROM THE TREBLE UNIT TO THE LISTENER IS LONGER THAN THAT OF THE MID/BASS UNIT. AS THE TREBLE UNIT DOME IS PHYSICALLY FORWARD OF THE MID/BASS UNIT CONE, THE DIFFERENCE IN PATH LENGTH HELPS TO EQUALISE THE ACOUSTIC DISTANCE.

SIMILARLY, THE LX-3 AND LX-4 FLOORSTANDERS POSITION THE TWEETER BETWEEN THE TWIN MID/BASS DRIVERS IN A 'D'APPOLITO' CONFIGURATION, RATHER THAN ABOVE BOTH DRIVERS IN CONVENTIONAL FASHION. THE THREE-WAY LX-5 IS OPTIMISED BY THE HF UNIT BEING POSITIONED BELOW THE MIDRANGE DRIVER AND ABOVE THE BASS DRIVER.

THE LX SERIES USES A 4TH ORDER ACOUSTIC (24DB PER OCTAVE) LINKWITZ-RILEY CROSSOVER NETWORK, DEVELOPED THROUGH A COMBINATION OF ADVANCED COMPUTER MODELLING, EXPERTISE AND MANY HOURS OF LISTENING TESTS. IT IS PARTICULARLY NOTABLE FOR ITS ABILITY TO BALANCE EXCELLENT OFF-AXIS PERFORMANCE WITH A FLATTER ON-AXIS RESULT. CROSSOVER COMPONENTS INCLUDE SILICON STEEL LAMINATED INDUCTORS AND POLYPROPYLENE FILM CAPACITORS.

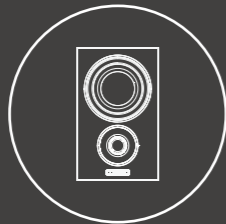

INVERTED DRIVER TECHNOLOGY

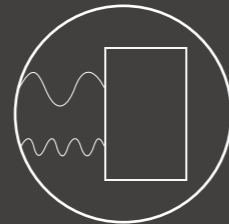

OPTIMISED TIME ALIGNMENT



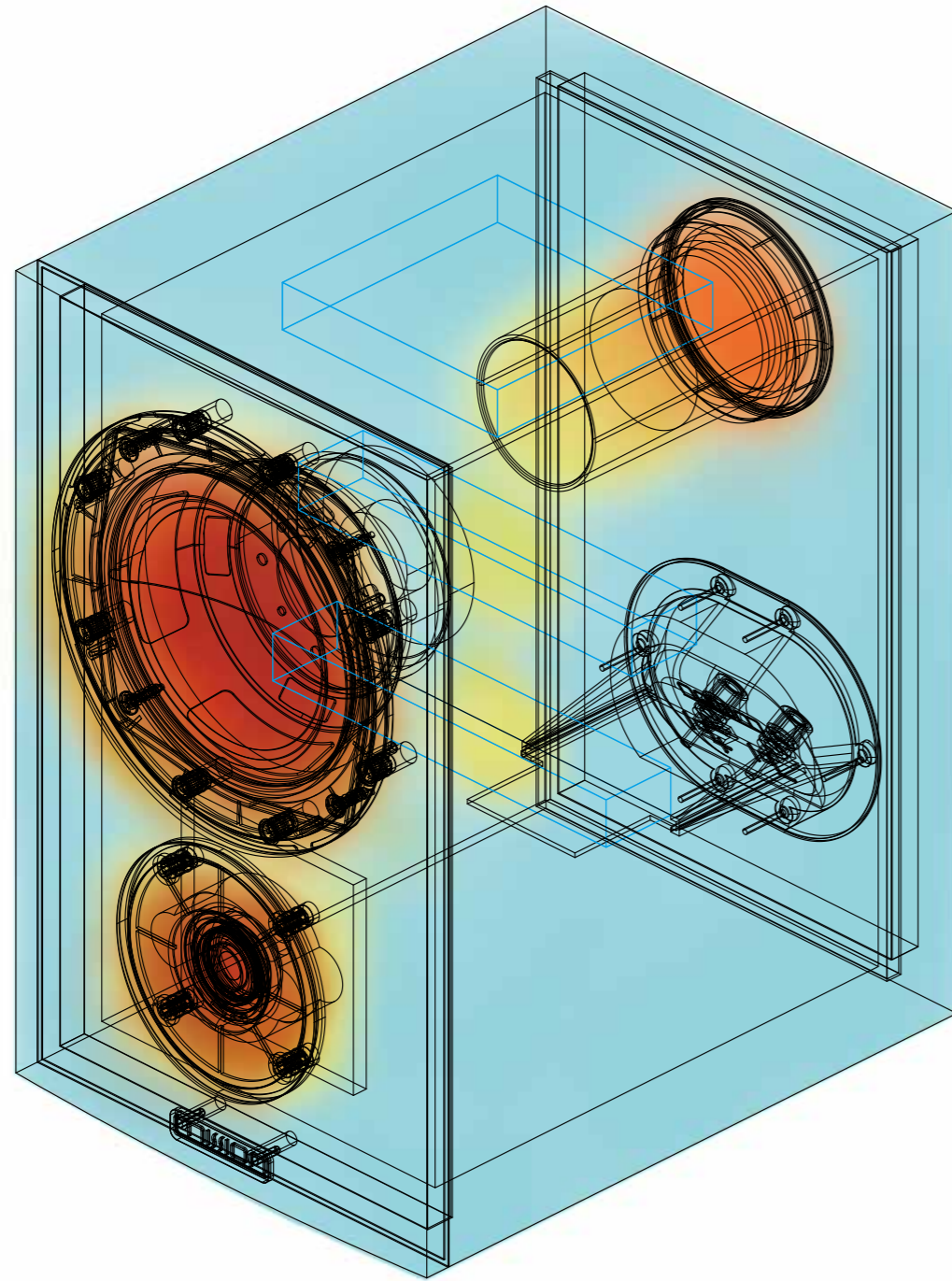

## TECHNOLOGY

# BRUTE STRENGTH

WHILE HIGH PERFORMANCE MID/BASS AND TREBLE UNITS ARE THE FOUNDATION OF A GREAT SOUNDING SPEAKER, IF THE CABINET IS NOT PROPERLY REINFORCED IT CAN BE AN UNRULY SOURCE OF UNWANTED NOISE.

EXTENSIVE RESEARCH AND DEVELOPMENT WAS CARRIED OUT TO ENSURE INTERNAL CABINET ROBUSTNESS, ELIMINATING ANY UNWANTED CABINET RESONANCES AND VIBRATIONS. USING A COMBINATION OF CAD ANALYSIS, A LOT OF EXPERIMENTATION AND EXTENSIVE LISTENING TESTS THE CABINET WITHIN EACH SPEAKER HAS BEEN BRACED AT KEY POINTS WHICH MEANS THE FULL FREQUENCY RANGE IS CLEAR AND DETAILED.

THE DIAGRAM SHOWS AREAS OF BRACING AND ITS EFFECT ON THE SOUND. BLUE AREAS SHOW WHERE NOISE IS REDUCED THROUGH CABINET BRACING, WHILE RED AREAS HIGHLIGHT WHERE THERE IS SOUND. AS YOU CAN SEE, THE SOUND IS SEEN EMANATING FROM THE DRIVERS AND NOT FROM THE CABINET, AS IT SHOULD BE.



STRENGTHENED CABINET

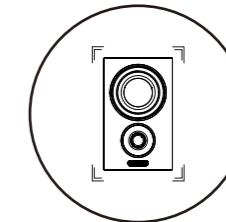

NO UNWANTED RESONANCE







# SPECIFICATIONS



MODEL	LX-1	LX-2	LX-3	LX-4	LX-5	LX-C
GENERAL DESCRIPTION	BOOKSHELF	BOOKSHELF	FLOOR-STANDING	FLOOR-STANDING	FLOOR-STANDING	CENTRE CHANNEL
ENCLOSURE TYPE	PORTED	PORTED	PORTED	PORTED	PORTED	CLOSED BOX
TRANSDUCER COMPLEMENT	2-WAY	2-WAY	2-WAY	2-WAY	3-WAY	2-WAY
MIDRANGE DRIVER					130MM ADVANCED FIBRE	
BASS DRIVER	100MM ADVANCED FIBRE	130MM ADVANCED FIBRE	2 X 130MM ADVANCED FIBRE	2 X 165MM ADVANCED FIBRE	2 X 165MM ADVANCED FIBRE	2 X 100MM ADVANCED FIBRE
TREBLE DRIVER	25MM MICROFIBRE DOME	25MM MICROFIBRE DOME	25MM MICROFIBRE DOME	25MM MICROFIBRE DOME	25MM MICROFIBRE DOME	25MM MICROFIBRE DOME
AV MAGNETICALLY SHIELDED	NO	NO	NO	NO	NO	YES
SENSITIVITY (1W @ 1M)	85DB	86.5DB	89.5DB	90DB	90DB	87.5DB
RECOMMENDED AMPLIFIER POWER	20-80W	20-100W	30-120W	15-150W	15-200W	20-100W
NOMINAL IMPEDANCE	6 OHMS	6 OHMS	6 OHMS	6 OHMS	6 OHMS	6 OHMS
MINIMUM IMPEDANCE	4.1 OHMS	4.4 OHMS	3.6 OHMS	3.7 OHMS	3.0 OHMS	5.0 OHMS
FREQUENCY RESPONSE (+/-3DB)	65-30KHZ	60-30KHZ	42-30KHZ	40-30KHZ	38-30KHZ	80-30KHZ
CROSSOVER FREQUENCY	2.2KHZ	2.8KHZ	2.2KHZ	2.2KHZ	580HZ/2.8KHZ	2.1KHZ
DIMENSIONS (MM)						
HEIGHT (ON PLINTH & SPIKES)	260MM	305MM	900+20MM	975+20MM	1000+20MM	160MM
WIDTH	160MM	191MM	191MM	214MM	214MM	400MM
DEPTH (WITH GRILLE)	225+10MM	250+10MM	265+10MM	300+10MM	325+10MM	200+10MM
CARTON SIZE	445 X 315 X 360MM	520 X 360 X 420MM	400 X 310 X 1025MM	440 X 340 X 1110MM	460 X 340 X 1140MM	500 X 310 X 280MM
NET WEIGHT	4.1KG	5.2KG	17.4KG	25.5KG	30KG	5.8KG
GROSS WEIGHT	9.4KG/CARTON	12.5KG/CARTON	20.3KG/CARTON	29 KG/CARTON	34KG/CARTON	7.0KG/CARTON
FINISH	BLACK WOOD /WALNUT /WHITE	BLACK WOOD /WALNUT /WHITE	BLACK WOOD /WALNUT /WHITE	BLACK WOOD /WALNUT /WHITE	BLACK WOOD /WALNUT /WHITE	BLACK WOOD /WALNUT /WHITE

